

WAFER TYPE BUTTERFLY VALVE

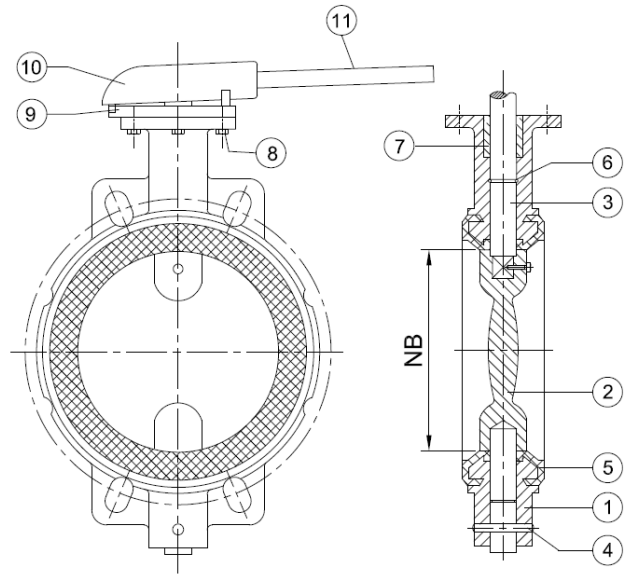

SL. NO.	DESCRIPTION	MATERIAL
1	BODY	CI / DI / CS
2	WEDGE	CI / DI / CS
3	SHAFT	SS:410/304/316/431
4	PIN	SS:410/304/316/431
5	LINING / SEATING	RUBBER
6	SHAFT 'O' RING	RUBBER
7	BUSH	TEFLON
8	BOLTS & NUTS	CAST STEEL
9	RACHET	CI / DI / CS
10	LEVER BOX	CI / DI / CS
11	LEVER	CARBON STEEL

DESIGN FEATURES	
SIZE RANGE	50 MM TO 400 MM
PRESSURE RATING	PN 1.0, PN 1.6
DESIGN STANDARD	BS 5155, IS:13095, AWWA C-504
TESTING STANDARD	IS: 13095
FLANGE STANDARD	BS / IS / ANSI / DIN
MATERIAL	CI / DI / CS
ACCESSORIES	GEAR, ACTUATOR, LEVER

HYDROSTATIC TEST PRESSURE (Kg/Cm ²)		
RATING	BODY	SEAT
PN 1.0	15	10
PN 1.6	24	16

DIMENSION TABLE

SL. No.	SIZE	FACE TO FACE	FLANGE DIA	FLANGE THICKNESS	PCD	NO. OF HOLE	HOLE DIA

ALL DIMENSIONS ARE IN MM.